

A stylized palm tree graphic with a brown trunk and green fronds, positioned behind the letter 'a' in the main title.

Royal Palm

Gorgona Beach

An aerial photograph of a modern high-rise building complex situated on a sandy beach. The building features a prominent central tower and several wings with a grid-like facade. The beach is wide and sandy, with gentle waves lapping at the shore. The water transitions from a shallow turquoise near the beach to a deeper blue further out. In the background, a city skyline with various high-rise buildings is visible under a clear blue sky. The foreground is dominated by lush green trees.

AS CLOSE AS YOU CAN GET TO THE BEACH

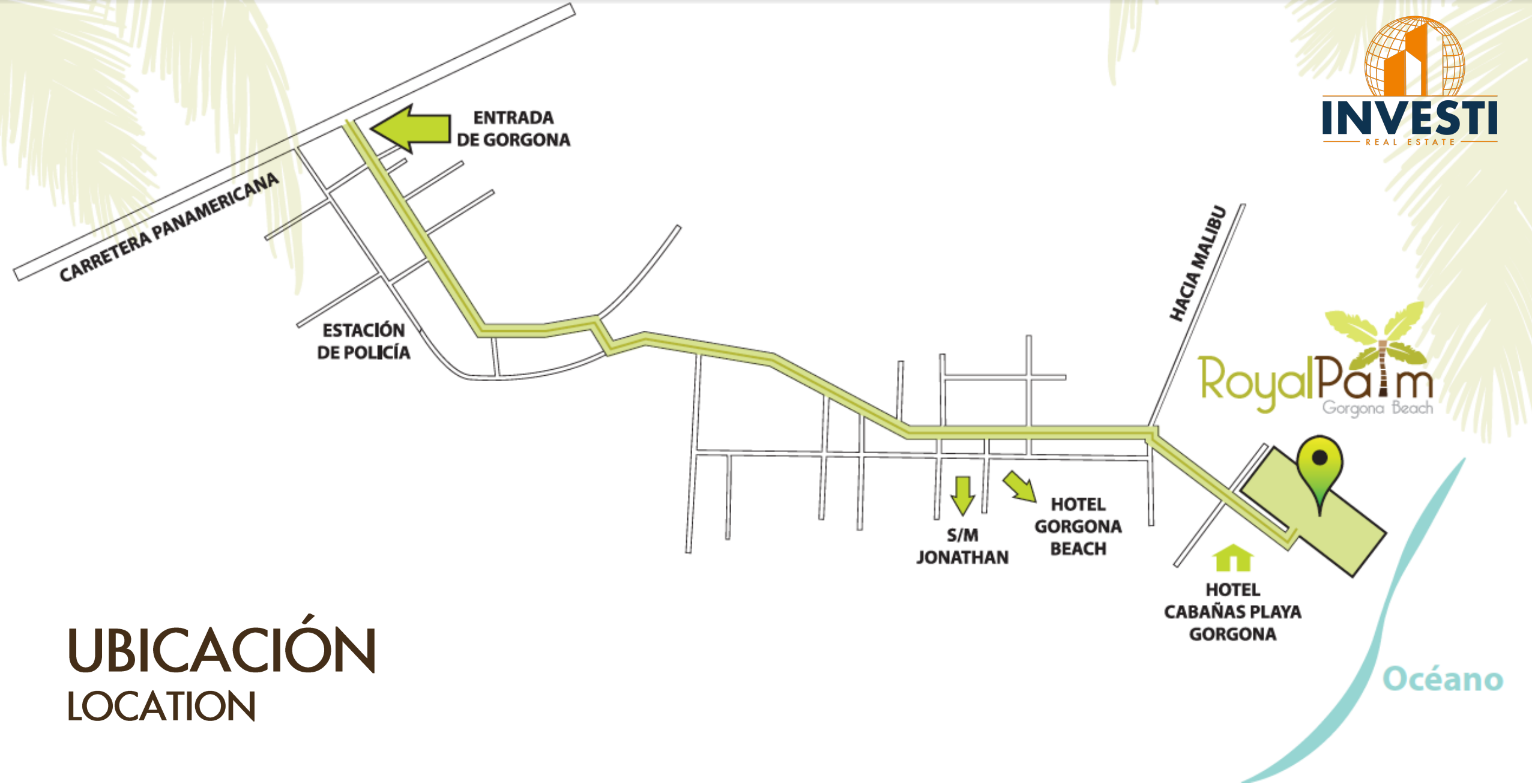

UBICACIÓN

LOCATION

EL PROYECTO

THE PROJECT

Royal Palm es un proyecto residencial frente al mar, con un diseño arquitectónico de vanguardia; situado en Playa Gorgona, a tan solo 50 minutos de la ciudad de Panamá.

Royal Palm is a beach front residential project with an innovative architectural design; located in Playa Gorgona, just 50 minutes From Panama City and minutes from Coronado



Dos torres de 28 y
21 niveles

Two towers 28 and 21
levels



70m², 128m² y
135m²

753.47 sq.ft., 1,377.80
sq.ft. and 1,454 sq.ft.



Torre A - 6 aptos x nivel
Torre B - 8 aptos x nivel

Tower A - 6 apts per level
Tower B - 8 apts per level



1 y 2 recámaras
1 and 2 bedrooms

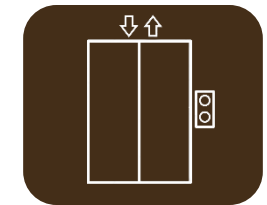

4 elevadores y 1 de
servicio

4 elevators and 1 cargo

EL EDIFICIO

THE BUILDING

- Torre A: Nivel 100 hasta 2400
- Torre B: Nivel 100 hasta 1900
- 281 apartamentos total
- 4 elevadores principales y 1 de carga
- Seguridad 24 horas
- Vestíbulo principal con recepción
- Dos áreas sociales
- Estacionamientos de visita

- Tower A: Level 100 to 2400
- Tower B: Level 100 to 1900
- 281 apartments in total
- 4 main elevators and 1 cargo
- 24 hour security
- Main lobby with front desk
- Two social areas
- Visitors parkings

AVANCE DE OBRA ENERO 2018

CONSTRUCTION IN PROGRESS JANUARY 2018



APARTAMENTOS

APARTMENTS

- De 70m², 128m² y 135m²
- 1 y 2 recámaras (todos los apartamentos de 70m² con posibilidad de unirse)
- Vista al Océano Pacífico
- Balcón

- 753.47 sq.ft., 1,377.80 sq.ft. and 1,454 sq.ft.
- 1 and 2 bedrooms (all 753.47sq.ft. units can be joined)
- View of the Pacific Ocean
- Balcony



PLANTA TÍPICA

FLOOR PLAN



TORRE B (NIVELES 100 - 1900)

TOWER B (LEVELS 100 - 1900)

TORRE A (NIVELES 100 - 2400)

TOWER A (LEVELS 100 - 2400)

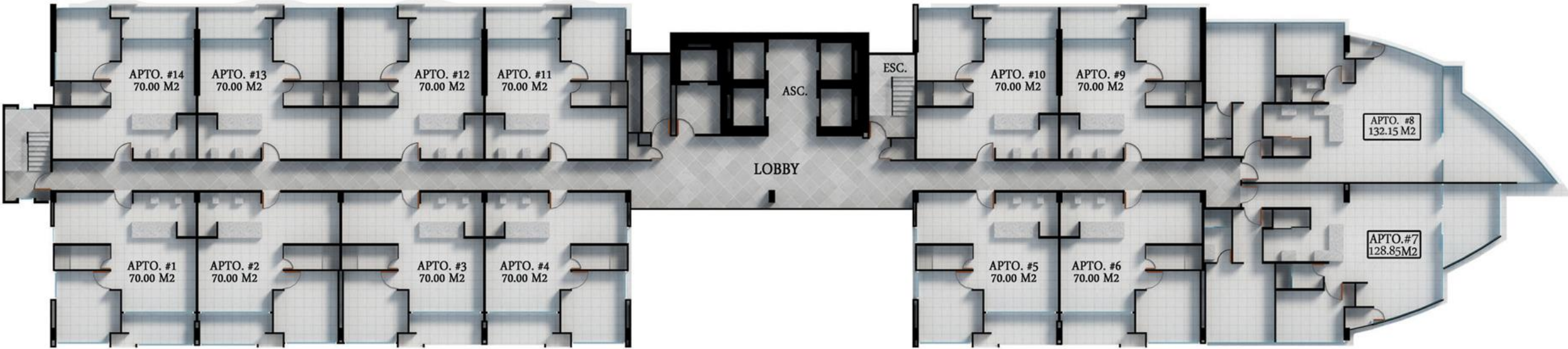

TODAS LAS UNIDADES TIENEN VISTA AL MAR

ALL UNITS HAVE VIEW TO THE OCEAN

APARTAMENTO – 70m²

APARTMENT – 753,47 sq.ft.

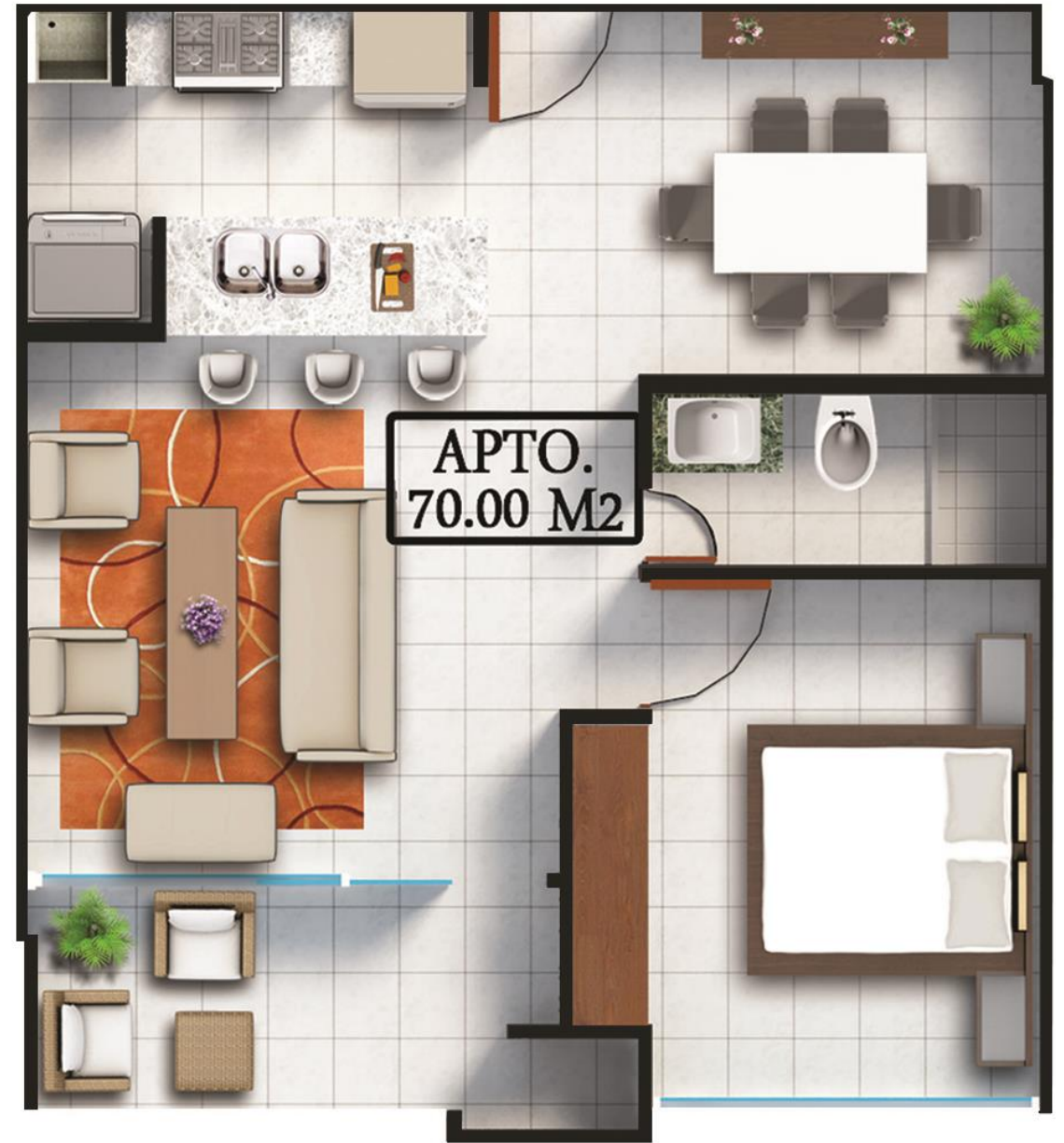

VISTA LATERAL AL MAR

LATERAL VIEW TO OCEAN

APARTAMENTO – 128m²

APARTMENT – 1,377.8 sq.ft.



VISTA AL MAR

VIEW TO OCEAN



APARTAMENTO – 132m²

APARTMENT – 1,420.8 sq.ft.

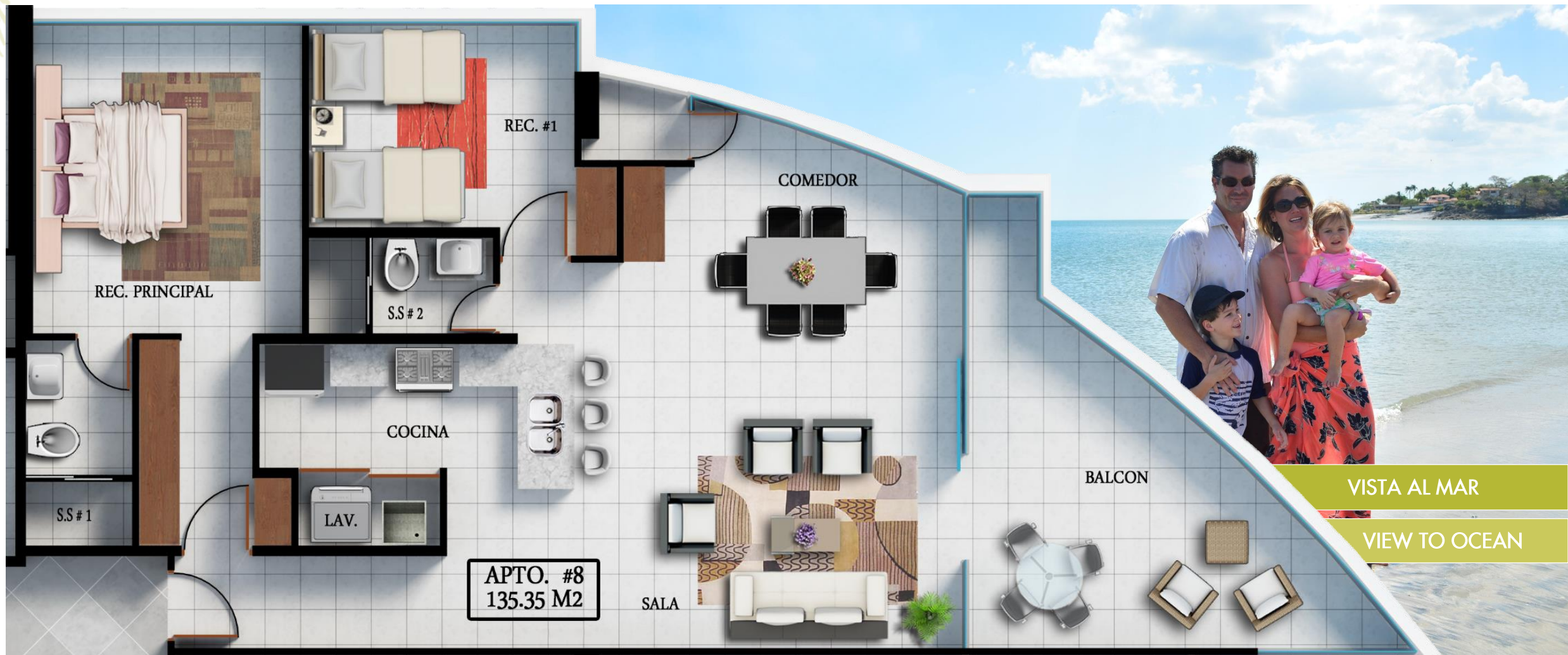

ÁREAS SOCIALES

SOCIAL AREAS

Dos áreas sociales:

- Planta Baja: incluye un restaurante, terraza techada, sun deck, piscina y acceso privado a la playa.
- Nivel 300: incluye cancha multiuso, terraza, sun deck, gimnasio, sauna, juegos para niños, salón de fiestas, jacuzzi y piscina familiar.

Two social areas:

- Ground Level: includes a restaurant, roofed terrace, sun deck, , pool and private beach access
- Level 300: includes multipurpose court, terrace, sun deck, gym, sauna, children's playground, room for private events, Jacuzzi and family pool.



PLANTA ÁREA SOCIAL

SOCIAL AREA FLOOR PLAN

NIVEL 300

LEVEL 300





LO MÁS CERCA QUE PUEDES ESTAR DE LA PLAYA

